

1YMLX – High pressure tube nipple metric – LH thread

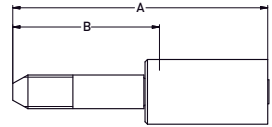

MATERIAL High strength carbon steel, zinc plated

#						A	B		
	DN	size	mm	inch				mm	mm
1YMLX-6-05	8	-05	7.9	5/16	M14x1.5-LH	110	66	150	21,750
1YMLX-11-08	12	-08	12.7	1/2	M18x1.5-LH	120	65	130	18,850

1YALX – High pressure tube nipple UNF – LH thread

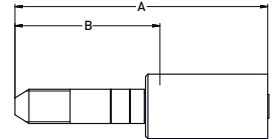

MATERIAL Special materials

#						A	B		
	DN	size	mm	inch				mm	mm
1YALX-1-025	4	-025	4.0	5/32	1/4 - 28UNF-LH	87	50	220	31,900
1YALX-3-025	4	-025	4.0	5/32	3/8 - 24UNF-LH	89	50	220	31,900
1YALX-1-03	5	-03	4.8	3/16	1/4 - 28UNF-LH	92	53	180	26,100
1YALX-3-03	5	-03	4.8	3/16	3/8 - 24UNF-LH	99	57	180	26,100
1YALX-6-03	5	-03	4.8	3/16	9/16 - 18UNF-LH	108	78	180	26,100
1YALX-3-04	6	-04	6.4	1/4	3/8 - 24UNF-LH	102	58	164	23,780
1YALX-6-04	6	-04	6.4	1/4	9/16 - 18UNF-LH	112	67	164	23,780
1YALX-6-05	8	-05	7.9	5/16	9/16 - 18UNF-LH	110	66	150	21,750