

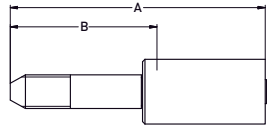



6YMWX – High pressure tube nipple metric – LH thread





MATERIAL Nipple: very high strength stainless steel
Shell and nut: high strength carbon steel, zinc plated

| # |  | | | |  | A | B |  | |
|---------------|---|------|-----|------|---|-----|----|--|--------|
| | DN | size | mm | inch | | | | mm | mm |
| 6YMWX-6-5C-55 | 8 | -05 | 7.9 | 5/16 | M14x1.5-LH | 130 | 63 | 380 | 55,000 |

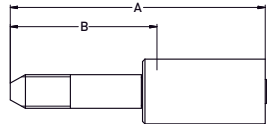
6Y4WX – High pressure tube nipple UNF – LH thread

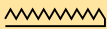

MATERIAL Nipple: very high strength stainless steel
Shell and nut: high strength carbon steel, zinc plated

| # |  | | | |  | A | B |  | |
|---------------|--|------|-----|------|--|-----|----|---|--------|
| | DN | size | mm | inch | | | | mm | mm |
| 6Y4WX-9-5C-55 | 8 | -05 | 7.9 | 5/16 | 9/16 - 18 UNF-LH | 130 | 63 | 380 | 55,000 |