

1C355 – Sealing Head Light Series – Metric Swivel Nut

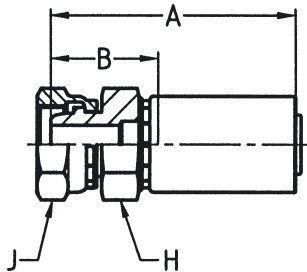

55 Series

Part No. #	DN size				Connection Type		A mm	B mm	H mm	J mm
	mm	inch	Thread Size	Tube OD						
1C355-6-3	5	-03	4.8	3/16	M12x1.5	6	52	27	14	14
1C355-8-4	6	-04	6.4	1/4	M14x1.5	8	59	27	17	19
1C355-10-4	6	-04	6.4	1/4	M16x1.5	8	59	27	19	19
1C355-10-5	8	-05	7.9	5/16	M16x1.5	10	59	27	19	19
1C355-12-5	8	-05	7.9	5/16	M18x1.5	12	61	29	19	24
1C355-10-6	10	-06	9.5	3/8	M16x1.5	10	66	29	19	22
1C355-12-6	10	-06	9.5	3/8	M18x1.5	12	66	29	19	24
1C355-15-8	12	-08	12.7	1/2	M22x1.5	15	72	31	24	27
1C355-18-12	20	-12	19.0	3/4	M26x1.5	18	80	34	32	32
1C355-22-12	20	-12	19.0	3/4	M30x2	22	84	38	32	36
1C355-28-16	25	-16	25.4	1	M36x2	28	97	37	36	46

Material: Steel, surface protection according to DIN 50 961 Fe/Zn, special materials available upon request

Note: 56 series is the recommended fitting type, as the availability of 55 series will be limited in the future.

1C455 – Sealing Head 45° Elbow Light Series – Metric Swivel Nut

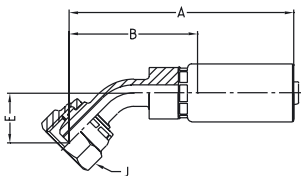

55 Series

Part No. #	DN size				Connection Type		A mm	B mm	E mm	J mm
	mm	inch	Thread Size	Tube OD						
1C455-6-3	5	-03	4.8	3/16	M12x1.5	6	67	42	16	14
1C455-8-4	6	-04	6.4	1/4	M14x1.5	8	73	42	16	19
1C455-10-5	8	-05	7.9	5/16	M16x1.5	10	74	43	17	19
1C455-10-6	10	-06	9.5	3/8	M16x1.5	10	81	45	17	19
1C455-12-6	10	-06	9.5	3/8	M18x1.5	12	82	45	18	22
1C455-15-8	12	-08	12.7	1/2	M22x1.5	15	91	50	20	27
1C455-22-12	20	-12	19.0	3/4	M30x2	22	107	61	24	36

Material: Steel, surface protection according to DIN 50 961 Fe/Zn, special materials available upon request

Note: 56 series is the recommended fitting type, as the availability of 55 series will be limited in the future.

1C555 – Sealing Head 90° Elbow Light Series – Metric Swivel Nut

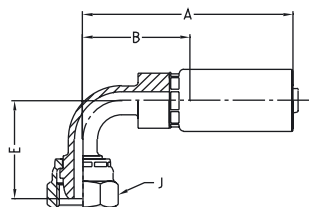

55 Series

Part No. #	DN size				Connection Type		A mm	B mm	E mm	J mm
	mm	inch	mm	inch	Thread Size	Tube OD				
1C555-6-3	5	-03	4.8	3/16	M12x1.5	6	57	32	29	14
1C555-8-4	6	-04	6.4	1/4	M14x1.5	8	64	32	29	19
1C555-10-4	6	-04	6.4	1/4	M16x1.5	10	64	32	29	19
1C555-10-5	8	-05	7.9	5/16	M16x1.5	10	65	33	30	19
1C555-10-6	10	-06	9.5	3/8	M16x1.5	10	73	36	33	19
1C555-12-6	10	-06	9.5	3/8	M18x1.5	12	73	36	34	22
1C555-15-6	10	-06	9.5	3/8	M22x1.5	15	73	36	36	27
1C555-15-8	12	-08	12.7	1/2	M22x1.5	15	82	41	41	27
1C555-18-12	20	-12	19.0	3/4	M26x1.5	18	100	54	52	32
1C555-22-12	20	-12	19.0	3/4	M30x2	22	100	54	52	36
1C555-28-16	25	-16	25.4	1	M36x2	28	131	71	68	46

Material: Steel, surface protection according to DIN 50 961 Fe/Zn, special materials available upon request

Note: 56 series is the recommended fitting type, as the availability of 55 series will be limited in the future.

1CA55 – 24° Sealing Cone / O-Ring Light Series – Metric Swivel Nut ISO 12151-2

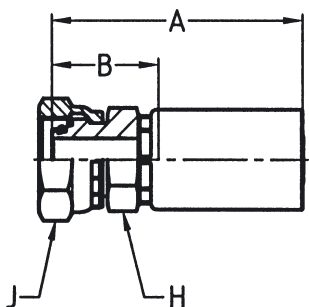

55 Series

Part No. #	DN size				Connection Type		A mm	B mm	H mm	J mm
	mm	inch	mm	inch	Thread Size	Tube OD				
1CA55-6-3	5	-03	4.8	3/16	M12x1.5	6	54	29	14	14
1CA55-8-4	6	-04	6.4	1/4	M14x1.5	8	60	29	17	19
1CA55-10-5	8	-05	7.9	5/16	M16x1.5	10	62	30	19	19
1CA55-12-5	8	-05	7.9	5/16	M18x1.5	12	63	31	19	22
1CA55-10-6	10	-06	9.5	3/8	M16x1.5	10	67	31	19	19
1CA55-12-6	10	-06	9.5	3/8	M18x1.5	12	68	31	19	22
1CA55-15-8	12	-08	12.7	1/2	M22x1.5	15	74	33	24	27
1CA55-18-12	20	-12	19.0	3/4	M26x1.5	18	80	34	32	32
1CA55-22-12	20	-12	19.0	3/4	M30x2	22	80	34	32	36
1CA55-28-16	25	-16	25.4	1	M36x2	28	101	41	36	46

Material: Steel, surface protection according to DIN 50 961 Fe/Zn, special materials available upon request

Note: 56 series is the recommended fitting type, as the availability of 55 series will be limited in the future.



1CE55 – 24° Sealing Cone / O-Ring 45° Elbow

Light Series – Metric Swivel Nut

ISO 12151-2

55 Series

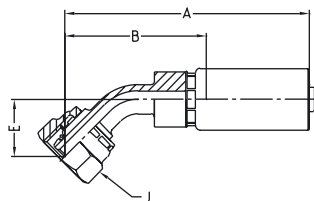

Part No. #	DN size mm inch				Connection Type		A mm	B mm	E mm	J mm
	mm	inch	Thread Size	Tube OD						
1CE55-6-3	5	-03	4.8	3/16	M12x1.5	6	67	42	16	14
1CE55-8-4	6	-04	6.4	1/4	M14x1.5	8	75	43	18	19
1CE55-10-4	6	-04	6.4	1/4	M16x1.5	10	75	43	17	19
1CE55-10-5	8	-05	7.9	5/16	M16x1.5	10	75	44	18	19
1CE55-10-6	10	-06	9.5	3/8	M16x1.5	10	83	46	19	19
1CE55-12-6	10	-06	9.5	3/8	M18x1.5	12	83	46	19	22
1CE55-15-8	12	-08	12.7	1/2	M22x1.5	15	92	51	21	27
1CE55-18-12	20	-12	19.0	3/4	M26x1.5	18	108	62	25	32
1CE55-22-12	20	-12	19.0	3/4	M30x2	22	108	62	26	36

Material: Steel, surface protection according to DIN 50 961 Fe/Zn, special materials available upon request

Note: 56 series is the recommended fitting type, as the availability of 55 series will be limited in the future.

1CF55 – Sealing Cone / O-Ring 90° Elbow

Light Series – Metric Swivel Nut

ISO 12151-2

55 Series

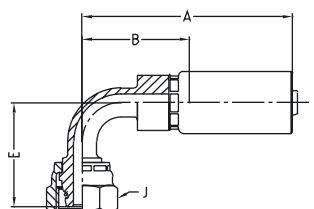

Part No. #	DN size mm inch				Connection Type		A mm	B mm	E mm	J mm
	mm	inch	Thread Size	Tube OD						
1CF55-6-3	5	-03	4.8	3/16	M12x1.5	6	55	30	29	14
1CF55-8-4	6	-04	6.4	1/6	M14x1.5	8	64	32	32	19
1CF55-10-4	6	-04	6.4	1/6	M16x1.5	10	64	32	31	19
1CF55-10-5	8	-05	7.9	5/16	M16x1.5	10	65	33	32	19
1CF55-12-5	8	-05	7.9	5/16	M18x1.5	12	65	33	32	22
1CF55-10-6	10	-06	9.5	3/8	M16x1.5	10	73	36	35	19
1CF55-12-6	10	-06	9.5	3/8	M18x1.5	12	73	36	35	22
1CF55-15-8	12	-08	12.7	1/2	M22x1.5	15	82	41	42	27
1CF55-18-12	20	-12	19.0	3/4	M26x1.5	18	100	54	54	32
1CF55-22-12	20	-12	19.0	3/4	M30x2	22	100	54	52	36
1CF55-28-16	25	-16	25.4	1	M36x2	28	122	62	65	46

Material: Steel, surface protection according to DIN 50 961 Fe/Zn, special materials available upon request

Note: 56 series is the recommended fitting type, as the availability of 55 series will be limited in the future.

1D055 – Metric Male 24° Cone

Light Series ISO 12151-2

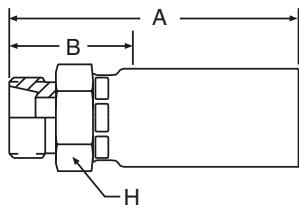

55 Series

Part No. #	DN size mm inch				Connection Type		A mm	B mm	H mm
					Thread Size 	Tube OD 			
1D055-6-3	5	-03	4.8	3/16	M12x1.5	6	49	23	17
1D055-8-4	6	-04	6.4	1/4	M14x1.5	8	55	23	19
1D055-10-5	8	-05	7.9	5/16	M16x1.5	10	58	26	19
1D055-12-5	8	-05	7.9	5/16	M18x1.5	12	59	27	19
1D055-10-6	10	-06	9.5	3/8	M16x1.5	10	63	26	22
1D055-12-6	10	-06	9.5	3/8	M18x1.5	12	64	27	22
1D055-15-6	10	-06	9.5	3/8	M22x1.5	15	67	30	27
1D055-15-8	12	-08	12.7	1/2	M22x1.5	15	71	30	27
1D055-18-12	20	-12	19.0	3/4	M26x1.5	18	76	30	32
1D055-22-12	20	-12	19.0	3/4	M30x2	22	77	31	36
1D055-28-16	25	-16	25.4	1	M36x2	28	91	31	41

Material: Steel, surface protection according to DIN 50 961 Fe/Zn, special materials available upon request

Note: 56 series is the recommended fitting type, as the availability of 55 series will be limited in the future.

11D55 – Metric Standpipe

Light Series

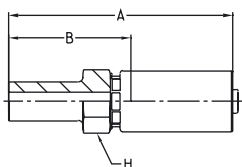

55 Series

Part No. #	DN size mm inch				Tube OD	A mm	B mm	H mm
11D55-6-2	3	-02	3.2	1/8	6	49	32	13
11D55-6-3	5	-03	4.8	3/16	6	59	33	14
11D55-6-4	6	-04	6.4	1/4	6	68	36	17
11D55-8-4	6	-04	6.4	1/4	8	68	37	17
11D55-10-5	8	-05	7.9	5/16	10	69	37	17
11D55-10-6	10	-06	9.5	3/8	10	74	37	19
11D55-12-6	10	-06	9.5	3/8	12	75	38	19
11D55-15-8	12	-08	12.7	1/2	15	82	41	22
11D55-18-8	12	-08	12.7	1/2	18	83	41	22
11D55-18-12	20	-12	19.0	3/4	18	89	43	30
11D55-22-12	20	-12	19.0	3/4	22	91	45	30
11D55-28-16	25	-16	25.4	1	28	107	47	41

Material: Steel, surface protection according to DIN 50 961 Fe/Zn, special materials available upon request

Note: 56 series is the recommended fitting type, as the availability of 55 series will be limited in the future.

Not recommended for new constructions. Please refer to end connections C3 or CA.



1C655 – Sealing Head

Heavy Series

Metric Swivel Nut

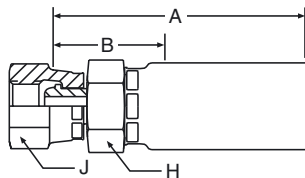

55 Series

Part No. #	DN size mm inch				Connection Type		A mm	B mm	H mm	J mm
	mm	inch	Thread Size	Tube OD						
1C655-8-3	5	-03	4.8	3/16	M16x1.5	8	53	28	17	19
1C655-10-4	6	-04	6.4	1/4	M18x1.5	10	60	28	19	22
1C655-12-5	8	-05	7.9	5/16	M20x1.5	12	64	32	22	24
1C655-14-6	10	-06	9.5	3/8	M22x1.5	14	66	30	24	27
1C655-16-8	12	-08	12.7	1/2	M24x1.5	16	72	31	27	30
1C655-20-12	20	-12	19.0	3/4	M30x2	20	84	38	32	36
1C655-25-12	20	-12	19.0	3/4	M36x2	25	82	36	36	46
1C655-30-16	25	-16	25.4	1	M42x2	30	102	42	38	50

Material: Steel, surface protection according to DIN 50 961 Fe/Zn, special materials available upon request

Note: 56 series is the recommended fitting type, as the availability of 55 series will be limited in the future.

1C955 – 24° Sealing Cone / O-Ring

Heavy Series – Metric Swivel Nut

ISO 12151-2

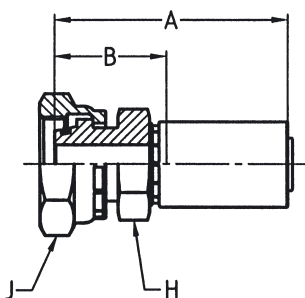

55 Series

Part No. #	DN size mm inch				Connection Type		A mm	B mm	H mm	J mm
	mm	inch	Thread Size	Tube OD						
1C955-8-3	5	-03	4.8	3/16	M16x1.5	8	54	29	17	19
1C955-8-4	6	-04	6.4	1/4	M18x1.5	8	70	38	17	19
1C955-10-4	6	-04	6.4	1/4	M18x1.5	10	67	36	19	22
1C955-12-4	6	-04	6.4	1/4	M20x1.5	12	64	32	19	24
1C955-10-5	8	-05	7.9	5/16	M18x1.5	10	63	32	19	22
1C955-12-5	8	-05	7.9	5/16	M20x1.5	12	63	32	19	24
1C955-12-6	10	-06	9.5	3/8	M20x1.5	12	68	32	19	24
1C955-14-6	10	-06	9.5	3/8	M22x1.5	14	70	33	24	27
1C955-16-8	12	-08	12.7	1/2	M24x1.5	16	77	36	24	30
1C955-20-12	20	-12	19.0	3/4	M30x2	20	84	38	30	36
1C955-25-12	20	-12	19.0	3/4	M36x2	25	88	42	36	46
1C955-30-16	25	-16	25.4	1	M42x2	30	104	44	41	50

Material: Steel, surface protection according to DIN 50 961 Fe/Zn, special materials available upon request

Note: 56 series is the recommended fitting type, as the availability of 55 series will be limited in the future.

10C55 – 24° Sealing Cone / O-Ring 45° Elbow

Heavy Series – Metric Swivel Nut

ISO 12151-2

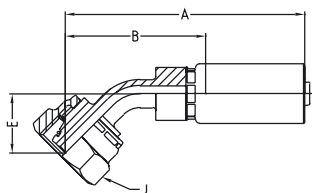

55 Series

Part No. #	DN size mm inch				Connection Type		A mm	B mm	E mm	J mm
	Thread Size	Tube OD								
10C55-8-3	5	-03	4.8	3/16	M16x1.5	8	68	43	18	19
10C55-16-8	12	-08	12.7	1/2	M24x1.5	16	93	52	23	30

Material: Steel, surface protection according to DIN 50 961 Fe/Zn, special materials available upon request

Note: 56 series is the recommended fitting type, as the availability of 55 series will be limited in the future.

11C55 – 24° Sealing Cone / O-Ring 90° Elbow

Heavy Series – Metric Swivel Nut

ISO 12151-2

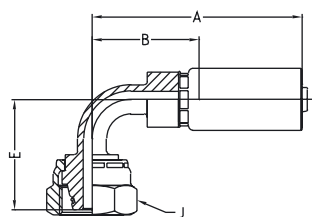

55 Series

Part No. #	DN size mm inch				Connection Type		A mm	B mm	E mm	J mm
	Thread Size	Tube OD								
11C55-10-4	6	-04	6.4	1/4	M18x1.5	10	64	32	31	22
11C55-12-5	8	-05	7.9	5/16	M20x1.5	12	65	33	34	24
11C55-12-6	10	-06	9.5	3/8	M20x1.5	12	73	36	37	24
11C55-16-8	12	-08	12.7	1/2	M24x1.5	16	82	41	44	30

Material: Steel, surface protection according to DIN 50 961 Fe/Zn, special materials available upon request

Note: 56 series is the recommended fitting type, as the availability of 55 series will be limited in the future.



1D255 – Metric Male 24° Cone Heavy Series ISO 12151-2

55 Series

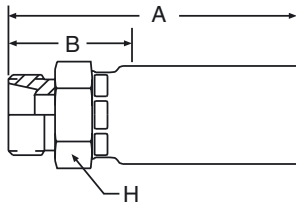

Part No. #	DN size mm inch				Connection Type		A mm	B mm	H mm
					Thread Size 	Tube OD 			
1D255-8-3	5	-03	4.8	3/16	M16x1.5	8	52	27	19
1D255-10-4	6	-04	6.4	1/4	M18x1.5	10	58	26	22
1D255-12-5	8	-05	7.9	5/16	M20x1.5	12	62	30	24
1D255-14-6	10	-06	9.5	3/8	M22x1.5	14	69	32	27
1D255-16-6	10	-06	9.5	3/8	M24x1.5	16	67	30	27
1D255-16-8	12	-08	12.7	1/2	M24x1.5	16	73	32	27
1D255-20-12	20	-12	19.0	3/4	M30x2	20	79	33	36
1D255-25-12	20	-12	19.0	3/4	M36x2	25	81	35	41
1D255-30-16	25	-16	25.4	1	M42x2	30	95	35	46

Material: Steel, surface protection according to DIN 50 961 Fe/Zn, special materials available upon request

Note: 56 series is the recommended fitting type, as the availability of 55 series will be limited in the future.

13D55 – Metric Standpipe Heavy Series

55 Series

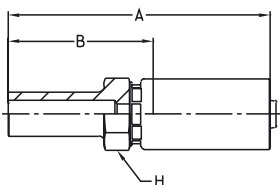

Part No. #	DN size mm inch				Tube OD	A mm	B mm	H mm
13D55-8-3	5	-03	4.8	3/16	8	61	35	14
13D55-8-4	6	-04	6.4	1/4	8	71	39	17
13D55-10-4	6	-04	6.4	1/4	10	70	38	17
13D55-12-5	8	-05	7.9	5/16	12	71	39	17
13D55-12-6	10	-06	9.5	3/8	12	76	39	19
13D55-14-6	10	-06	9.5	3/8	14	81	44	19
13D55-16-8	12	-08	12.7	1/2	16	87	46	22
13D55-20-12	20	-12	19.0	3/4	20	98	52	30
13D55-25-12	20	-12	19.0	3/4	25	103	57	30
13D55-30-16	25	-16	25.4	1	30	116	56	41

Material: Steel, surface protection according to DIN 50 961 Fe/Zn, special materials available upon request

Note: 56 series is the recommended fitting type, as the availability of 55 series will be limited in the future.

Not recommended for new constructions. Please refer to end connections C9.

19255 – Sealing Head (60°) BSP Swivel Nut

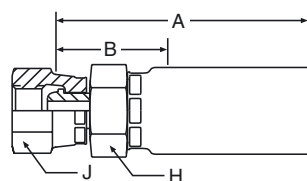

55 Series

Part No. #	DN size mm inch				Connection Type		A mm	B mm	H mm	J mm
	mm	inch	mm	inch	Thread Size	Tube OD				
19255-4-3	5	-03	4.8	3/16	G 1/4	1/4	53	28	17	19
19255-2-4	6	-04	6.4	1/4	G 1/8	1/8	57	25	17	14
19255-4-4	6	-04	6.4	1/4	G 1/4	1/4	58	26	17	19
19255-6-4	6	-04	6.4	1/4	G 3/8	3/8	59	27	17	22
19255-4-5	8	-05	7.9	5/16	G 1/4	1/4	59	27	19	19
19255-6-5	8	-05	7.9	5/16	G 3/8	3/8	59	27	19	22
19255-6-6	10	-06	9.5	3/8	G 3/8	3/8	64	27	19	22
19255-8-6	12	-08	12.7	1/2	G 1/2	1/2	67	30	24	27
19255-10-8	12	-08	12.7	1/2	G 5/8	5/8	75	34	27	30
19255-12-12	20	-12	19.0	3/4	G 3/4	3/4	81	35	32	32
19255-16-16	25	-16	25.4	1	G 1	1	99	39	36	41

Material: Steel, surface protection according to DIN 50 961 Fe/Zn, special materials available upon request

Note: 56 series is the recommended fitting type, as the availability of 55 series will be limited in the future.

1B155 – Sealing Head (60°) 45° Elbow BSP Swivel Nut

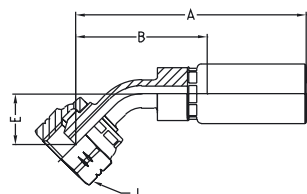

55 Series

Part No. #	DN size mm inch				Connection Type		A mm	B mm	E mm	J mm
	mm	inch	mm	inch	Thread Size	Tube OD				
1B155-4-4	6	-04	6.4	1/4	G 1/4	1/4	73	41	16	19
1B155-6-5	8	-05	7.9	5/16	G 3/8	3/8	74	42	16	22
1B155-6-6	10	-06	9.5	3/8	G 3/8	3/8	81	45	17	22
1B155-8-8	12	-08	12.7	1/2	G 1/2	1/2	91	49	20	27
1B155-10-8	12	-08	12.7	1/2	G 5/8	5/8	89	48	19	30
1B155-12-12	20	-12	19.0	3/4	G 3/4	3/4	107	61	25	32
1B155-16-16	25	-16	25.4	1	G 1	1	131	71	29	41

Material: Steel, surface protection according to DIN 50 961 Fe/Zn, special materials available upon request

Note: 56 series is the recommended fitting type, as the availability of 55 series will be limited in the future.

1B255 – Sealing Head (60°) 90° Elbow BSP Swivel Nut

55 Series

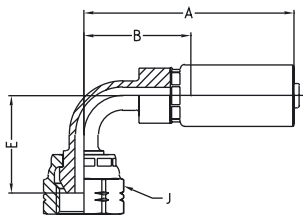

Part No. #	DN size mm inch				Connection Type		A mm	B mm	E mm	J mm
	mm	inch	mm	inch	Thread Size	Tube OD				
1B255-4-3	5	-03	4.8	3/16	G 1/4	1/4	57	32	28	19
1B255-4-4	6	-04	6.4	1/4	G 1/4	1/4	64	32	28	19
1B255-6-5	8	-05	7.9	5/16	G 3/8	3/8	65	33	30	22
1B255-6-6	10	-06	9.5	3/8	G 3/8	3/8	73	36	33	22
1B255-8-8	12	-08	12.7	1/2	G 1/2	1/2	82	41	40	27
1B255-10-8	12	-08	12.7	1/2	G 5/8	5/8	82	41	38	30
1B255-12-12	20	-12	19.0	3/4	G 3/4	3/4	100	54	53	32
1B255-16-16	25	-16	25.4	1	G 1	1	127	67	65	41

Material: Steel, surface protection according to DIN 50 961 Fe/Zn, special materials available upon request

Note: 56 series is the recommended fitting type, as the availability of 55 series will be limited in the future.

1B455 – BSP – Swivel Female 90° Compact Elbow

55 Series

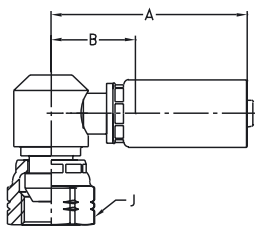

Part No. #	DN size mm inch				Connection Type		A mm	B mm	J mm
	mm	inch	mm	inch	Thread Size	Tube OD			
1B455-4-4	6	-04	6.4	1/4	G 1/4	1/4	53	21	19
1B455-6-6	10	-06	9.5	3/8	G 3/8	3/8	61	25	22
1B455-8-8	12	-08	12.7	1/2	G 1/2	1/2	68	27	27

Material: Steel, surface protection according to DIN 50 961 Fe/Zn, special materials available upon request

Note: 56 series is the recommended fitting type, as the availability of 55 series will be limited in the future.

1D955 – BSP Male DIN 3852 Shape A

55 Series

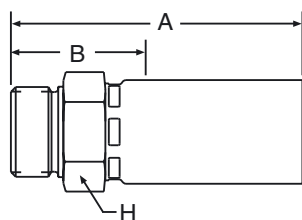

Part No. #	DN size mm inch				Connection Type		A mm	B mm	H mm
	mm		inch		Thread Size	Tube OD			
1D955-4-4	6	-04	6.4	1/4	G 1/4	1/4	58	26	19
1D955-6-5	8	-05	7.9	5/16	G 3/8	3/8	59	27	22
1D955-6-6	10	-06	9.5	3/8	G 3/8	3/8	64	27	22
1D955-8-8	12	-08	12.7	1/2	G 1/2	1/2	72	31	27
1D955-12-12	20	-12	19.0	3/4	G 3/4	3/4	80	34	32
1D955-16-16	25	-16	25.4	1	G 1	1	95	35	41

Material: Steel, surface protection according to DIN 50 961 Fe/Zn, special materials available upon request

Note: 56 series is the recommended fitting type, as the availability of 55 series will be limited in the future.

10155 – NPTF Male - 60° Cone

55 Series

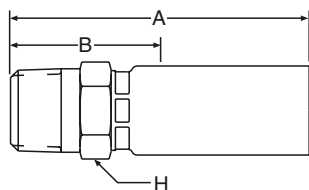

Part No. #	DN size mm inch				Connection Type		A mm	B mm	H mm
	mm		inch		Thread Size	Tube OD			
10155-2-3	5	-03	4.8	3/16	1/8 - 27NPTF	1/8	51	26	14
10155-4-3	5	-03	4.8	3/16	1/4 - 18NPTF	1/4	55	30	17
10155-6-3	5	-03	4.8	3/16	3/8 - 18NPTF	3/8	54	29	19
10155-2-4	6	-04	6.4	1/4	1/8 - 27NPTF	1/8	54	22	17
10155-4-4	6	-04	6.4	1/4	1/4 - 18NPTF	1/4	62	30	17
10155-6-4	6	-04	6.4	1/4	3/8 - 18NPTF	3/8	61	29	19
10155-4-5	8	-05	7.9	5/16	1/4 - 18NPTF	1/4	59	27	17
10155-6-5	8	-05	7.9	5/16	3/8 - 18NPTF	3/8	61	29	19
10155-4-6	10	-06	9.5	3/8	1/4 - 18NPTF	1/4	66	30	19
10155-6-6	10	-06	9.5	3/8	3/8 - 18NPTF	3/8	70	33	19
10155-8-6	10	-06	9.5	3/8	1/2 - 14NPTF	1/2	77	40	27
10155-6-8	12	-08	12.7	1/2	3/8 - 18NPTF	3/8	71	30	22
10155-8-8	12	-08	12.7	1/2	1/2 - 14NPTF	1/2	77	36	27
10155-12-12	20	-12	19.0	3/4	3/4 - 14NPTF	3/4	82	36	30
10155-16-16	25	-06	25.4	1	1 - 11 1/2NPTF	1	104	44	41

Material: Steel, surface protection according to DIN 50 961 Fe/Zn, special materials available upon request

Note: 56 series is the recommended fitting type, as the availability of 55 series will be limited in the future.

10355 – JIC Male 37° Cone

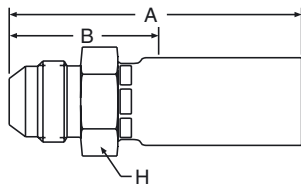

55 Series

Part No. #	DN size mm inch				Connection Type		A mm	B mm	H mm
	mm	inch	Thread Size	Tube OD					
10355-4-3	5	-03	4.8	3/16	7/16 - 20UNF	1/4	52	27	14
10355-4-4	6	-04	6.4	1/4	7/16 - 20UNF	1/4	58	27	17
10355-5-4	6	-04	6.4	1/4	1/2 - 20UNF	5/16	58	27	17
10355-6-4	6	-04	6.4	1/4	1/2 - 20UNF	5/16	59	27	17
10355-5-5	8	-05	7.9	5/16	9/16 - 18UNF	3/8	62	30	17
10355-6-5	8	-05	7.9	5/16	9/16 - 18UNF	3/8	62	30	17
10355-6-6	10	-06	9.5	3/8	9/16 - 18UNF	3/8	70	33	19
10355-8-6	10	-06	9.5	3/8	3/4 - 16UNF	1/2	68	32	22
10355-8-8	12	-08	12.7	1/2	3/4 - 16UNF	1/2	73	32	22
10355-10-8	12	-08	12.7	1/2	7/8 - 14UNF	5/8	81	40	27
10355-12-12	20	-12	19.0	3/4	1 1/16 - 12UNF	3/4	84	38	30
10355-16-16	25	-06	25.4	1	1 5/16 - 12UNF	1	104	44	36

Material: Steel, surface protection according to DIN 50 961 Fe/Zn, special materials available upon request

Note: 56 series is the recommended fitting type, as the availability of 55 series will be limited in the future.

10555 – UNF Male / O-Ring

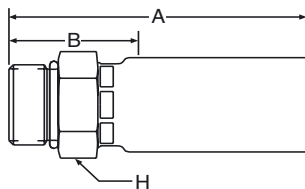

55 Series

Part No. #	DN size mm inch				Connection Type		A mm	B mm	H mm
	mm	inch	Thread Size	Tube OD					
10555-4-3	5	-03	4.8	3/16	7/16 - 20UNF	1/4	47	22	14
10555-4-4	6	-04	6.4	1/4	7/16 - 20UNF	1/4	57	25	17
10555-5-4	6	-04	6.4	1/4	1/2 - 20UNF	5/16	54	22	17
10555-6-4	6	-04	6.4	1/4	9/16 - 18UNF	3/8	58	26	19
10555-4-5	8	-05	7.9	5/16	7/16 - 20UNF	1/4	53	22	17
10555-5-5	8	-05	7.9	5/16	1/2 - 20UNF	5/16	53	22	17
10555-6-6	10	-06	9.5	3/8	9/16 - 18UNF	3/8	61	25	19
10555-8-6	10	-06	9.5	3/8	3/4 - 16UNF	1/2	63	26	22
10555-8-8	12	-08	12.7	1/2	3/4 - 16UNF	1/2	67	26	22
10555-10-8	12	-08	12.7	1/2	7/8 - 14UNF	5/8	70	29	24

Material: Steel, surface protection according to DIN 50 961 Fe/Zn, special materials available upon request

Note: 56 series is the recommended fitting type, as the availability of 55 series will be limited in the future.

10655 – JIC - 37° Cone

UNF Swivel Nut

Material: Steel

55 Series

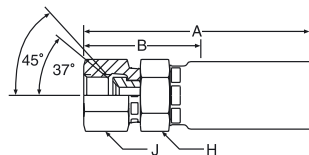

Part No. #	DN size mm inch		Connection Type				A mm	B mm	H mm	J mm
			Thread Size	Tube OD						
10655-4-2	3	-02	3.2	1/8	7/16 - 20UNF	1/4	44	27	13	16
10655-4-3	5	-03	4.8	3/16	7/16 - 20UNF	1/4	55	30	16	17
10655-5-3	5	-03	4.8	3/16	1/2 - 20UNF	5/16	57	32	16	17
10655-4-4	6	-04	6.4	1/4	7/16 - 20UNF	1/4	65	33	17	17
10655-5-4	6	-04	6.4	1/4	1/2 - 20UNF	5/16	65	33	16	17
10655-6-4	6	-04	6.4	1/4	9/16 - 18UNF	3/8	67	35	17	19
10655-5-5	8	-05	7.9	5/16	1/2 - 20UNF	5/16	65	33	16	17
10655-6-5	8	-05	7.9	5/16	9/16 - 18UNF	3/8	65	33	16	19
10655-8-5	8	-05	7.9	5/16	3/4 - 16UNF	1/2	68	37	19	22
10655-6-6	10	-06	9.5	3/8	9/16 - 18UNF	3/8	69	33	19	19
10655-8-6	10	-06	9.5	3/8	3/4 - 16UNF	1/2	72	35	19	24
10655-6-8	12	-08	12.7	1/2	9/16 - 18UNF	3/8	76	35	22	19
10655-8-8	12	-08	12.7	1/2	3/4 - 16UNF	1/2	79	38	22	22
10655-10-8	12	-08	12.7	1/2	7/8 - 14UNF	5/8	82	41	22	27
10655-12-8	12	-08	12.7	1/2	1 1/16 - 12UNF	3/4	83	42	27	32
10655-12-12	20	-12	19.0	3/4	1 1/16 - 12UNF	3/4	88	42	30	32
10655-16-16	25	-16	25.4	1	1 5/16 - 12UNF	1	104	44	36	38

Material: Steel, surface protection according to DIN 50 961 Fe/Zn, special materials available upon request

Note: 56 series is the recommended fitting type, as the availability of 55 series will be limited in the future.

Material: Stainless Steel (AISI 316)



Part No. #	DN size mm inch		Connection Type				A mm	B mm	H mm	J mm
			Thread Size	Tube OD						
10655-4-3C	5	-03	4.8	3/16	7/16 - 20UNF	1/4	55	30	16	17
10655-4-4C	6	-04	6.4	1/4	7/16 - 20UNF	1/4	65	33	17	17
10655-5-4C	6	-04	6.4	1/4	1/2 - 20UNF	5/16	65	33	16	17
10655-6-4C	6	-04	6.4	1/4	9/16 - 18UNF	3/8	67	35	17	19
10655-6-5C	8	-05	7.9	5/16	9/16 - 18UNF	3/8	65	33	16	19
10655-6-6C	10	-06	9.5	3/8	9/16 - 18UNF	3/8	69	33	19	19
10655-8-6C	10	-06	9.5	3/8	3/4 - 16UNF	1/2	72	35	19	24
10655-8-8C	12	-08	12.7	1/2	3/4 - 16UNF	1/2	79	38	22	22
10655-10-8C	12	-08	12.7	1/2	7/8 - 14UNF	5/8	82	41	22	27
10655-12-12C	20	-12	19.0	3/4	1 1/16 - 12UNF	3/4	88	42	30	32
10655-16-16C	25	-16	25.4	1	1 5/16 - 12UNF	1	104	44	36	38

Material: Stainless steel (AISI 316)

Note: 56 series is the recommended fitting type, as the availability of 55 series will be limited in the future.

13755 – JIC - 37° Cone 45° Elbow UNF Swivel Nut

55 Series

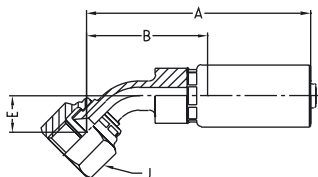

Part No. #	DN size mm inch				Connection Type		A mm	B mm	E mm	J mm
	mm	inch	Thread Size	Tube OD						
13755-4-3-SM	5	-03	4.8	3/16	7/16 - 20UNF	1/4	61	30	11	17
13755-4-4-SM	6	-04	6.4	1/4	7/16 - 20UNF	1/4	68	36	10	17
13755-5-4-SM	6	-04	6.4	1/4	1/2 - 20UNF	5/16	70	38	13	17
13755-6-5-SM	8	-05	7.9	5/16	9/16 - 18UNF	3/8	69	37	11	19
13755-6-6-SM	10	-06	9.5	3/8	9/16 - 18UNF	3/8	77	40	14	19
13755-8-6-SM	10	-06	9.5	3/8	3/4 - 16UNF	1/2	78	42	15	22
13755-8-8-SM	12	-08	12.7	1/2	3/4 - 16UNF	1/2	83	42	14	22
13755-10-8-SM	12	-08	12.7	1/2	7/8 - 14UNF	5/8	85	44	16	27
13755-12-12-SM	20	-12	19.0	3/4	1 1/16 - 12UNF	3/4	100	54	20	32
13755-16-16-SM	25	-16	25.4	1	1 5/16 - 12UNF	1	124	64	24	41

Material: Steel, surface protection according to DIN 50 961 Fe/Zn, special materials available upon request

Note: 56 series is the recommended fitting type, as the availability of 55 series will be limited in the future.

13955 – JIC - 37° Cone 90° Elbow UNF Swivel Nut

55 Series

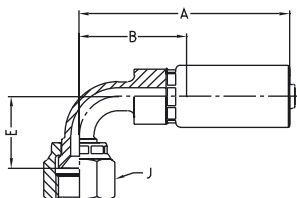

Part No. #	DN size mm inch				Connection Type		A mm	B mm	E mm	J mm
	mm	inch	Thread Size	Tube OD						
13955-4-3-SM	5	-03	4.8	3/16	7/16 - 20UNF	1/4	55	30	21	17
13955-4-4-SM	6	-04	6.4	1/4	7/16 - 20UNF	1/4	64	32	21	17
13955-5-4-SM	6	-04	6.4	1/4	1/2 - 20UNF	5/16	64	32	25	17
13955-6-4-SM	6	-04	6.4	1/4	9/16 - 18UNF	3/8	64	32	22	19
13955-6-5-SM	8	-05	7.9	5/16	9/16 - 18UNF	3/8	65	33	22	19
13955-6-6-SM	10	-06	9.5	3/8	9/16 - 18UNF	3/8	73	36	28	19
13955-8-6-SM	10	-06	9.5	3/8	3/4 - 16UNF	1/2	71	34	29	22
13955-8-8-SM	12	-08	12.7	1/2	3/4 - 16UNF	1/2	77	36	29	22
13955-10-8-SM	12	-08	12.7	1/2	7/8 - 14UNF	5/8	77	36	32	27
13955-12-12-SM	20	-12	19.0	3/4	1 1/16 - 12UNF	3/4	97	51	46	32
13955-16-16-SM	25	-16	25.4	1	1 5/16 - 12UNF	1	121	61	55	41

Material: Steel, surface protection according to DIN 50 961 Fe/Zn, special materials available upon request

Note: 56 series is the recommended fitting type, as the availability of 55 series will be limited in the future.

1JC55 – O-Lok® ORFS (Short Version) UNF Swivel Nut ISO 12151-1

55 Series

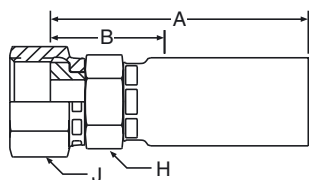

Part No. #	DN size mm inch				Connection Type		A mm	B mm	H mm	J mm
					Thread Size 	Tube OD 				
1JC55-4-3-SM	5	-03	4.8	3/16	9/16 - 18UNF	1/4	47	22	17	17
1JC55-4-4-SM	6	-04	6.4	1/4	9/16 - 18UNF	1/4	53	22	17	17
1JC55-6-4-SM	6	-04	6.4	1/4	11/16 - 16UNF	3/8	59	27	19	22
1JC55-4-5-SM	8	-05	7.9	5/16	9/16 - 16UNF	1/4	53	22	17	17
1JC55-6-5-SM	8	-05	7.9	5/16	11/16 - 16UNF	3/8	56	25	19	22
1JC55-6-6-SM	10	-06	9.5	3/8	11/16 - 16UNF	3/8	61	25	19	22
1JC55-8-6-SM	10	-06	9.5	3/8	13/16 - 16UNF	1/2	63	27	22	24
1JC55-8-8-SM	12	-08	12.7	1/2	13/16 - 16UNF	1/2	69	27	24	24
1JC55-10-8-SM	12	-08	12.7	1/2	1 - 14UNF	5/8	73	32	30	30
1JC55-12-12-SM	20	-12	19.0	3/4	1 3/16 - 12UNF	3/4	79	33	32	36
1JC55-16-16-SM	25	-16	25.4	1	1 7/16 - 12UNF	1	96	36	36	41

Material: Steel, surface protection according to DIN 50 961 Fe/Zn, special materials available upon request

Note: 56 series is the recommended fitting type, as the availability of 55 series will be limited in the future.

1JS55 – O-Lok® ORFS UNF Swivel Nut ISO 12151-1

55 Series

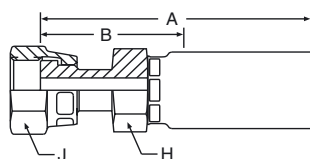

Part No. #	DN size mm inch				Connection Type		A mm	B mm	H mm	J mm
					Thread Size 	Tube OD 				
1JS55-4-3-SM	5	-03	4.8	3/16	9/16 - 18UNF	1/4	60	35	17	17
1JS55-4-4-SM	6	-04	6.4	1/4	9/16 - 18UNF	1/4	67	35	17	17
1JS55-6-4-SM	6	-04	6.4	1/4	11/16 - 16UNF	3/8	66	35	19	22
1JS55-4-5-SM	8	-05	7.9	5/16	9/16 - 16UNF	1/4	67	35	17	17
1JS55-6-5-SM	8	-05	7.9	5/16	11/16 - 16UNF	3/8	66	35	19	22
1JS55-6-6-SM	10	-06	9.5	3/8	11/16 - 16UNF	3/8	71	35	19	22
1JS55-8-6-SM	10	-06	9.5	3/8	13/16 - 16UNF	1/2	75	38	22	24
1JS55-8-8-SM	12	-08	12.7	1/2	13/16 - 16UNF	1/2	80	38	22	24
1JS55-10-10-SM	16	-10	15.9	5/8	1 - 14UNF	5/8	90	44	30	30
1JS55-12-12-SM	20	-12	19.0	3/4	1 3/16 - 12UNF	3/4	94	48	32	36
1JS55-16-16-SM	25	-16	25.4	1	1 7/16 - 12UNF	1	112	52	36	41



Material: Steel, surface protection according to DIN 50 961 Fe/Zn, special materials available upon request

Note: 56 series is the recommended fitting type, as the availability of 55 series will be limited in the future.

1JM55 – O-Lok® ORFS Male ISO 12151-1

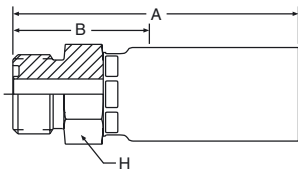
55 Series



Part No. #	DN size mm inch				Connection Type		A mm	B mm	H mm
					Thread Size 	Tube OD 			
1JM55-4-4-SM	6	-04	6.4	1/4	9/16 - 18UNF	1/4	56	24	19
1JM55-6-6-SM	10	-06	9.5	3/8	11/16 - 16UNF	3/8	63	26	19
1JM55-8-6-SM	10	-06	9.5	3/8	13/16 - 16UNF	1/2	65	28	22



Material: Steel, surface protection according to DIN 50 961 Fe/Zn, special materials available upon request

Note: 56 series is the recommended fitting type, as the availability of 55 series will be limited in the future.

1J755 – O-Lok® ORFS 45° Elbow UNF Swivel Nut ISO 12151-1

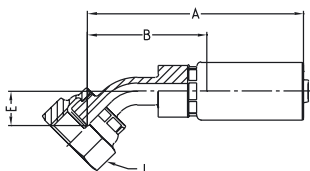
55 Series



Part No. #	DN size mm inch				Connection Type		A mm	B mm	E mm	H mm
					Thread Size 	Tube OD 				
1J755-4-4	6	-04	6.4	1/4	9/16 - 18UNF	5/16	71	39	10	17
1J755-6-4	6	-04	6.4	1/4	11/16 - 16UNF	3/8	73	41	12	22
1J755-6-6	10	-06	9.5	3/8	11/16 - 16UNF	3/8	78	41	14	22
1J755-8-6	10	-06	9.5	3/8	13/16 - 16UNF	1/2	78	42	14	24
1J755-8-8	12	-08	12.7	1/2	13/16 - 16UNF	1/2	83	42	12	24
1J755-12-12	20	-12	19.0	3/4	1 3/16 - 12UNF	3/4	103	57	21	36
1J755-16-16	25	-16	25.4	1	1 7/16 - 12UNF	1	130	70	26	41

Material: Steel, surface protection according to DIN 50 961 Fe/Zn, special materials available upon request

Note: 56 series is the recommended fitting type, as the availability of 55 series will be limited in the future.

1J955 – O-Lok® ORFS 90° Elbow UNF Swivel Nut ISO 12151-1

55 Series

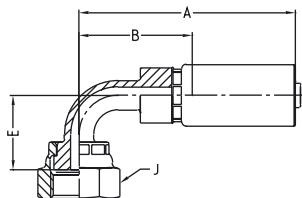

Part No. #	DN size mm inch				Connection Type		A mm	B mm	E mm	J mm
	mm	inch	Thread Size	Tube OD						
1J955-4-4	6	-04	6.4	1/4	9/16 - 18UNF	5/16	67	35	21	17
1J955-6-4	6	-04	6.4	1/4	11/16 - 16UNF	3/8	68	36	23	22
1J955-6-5	8	-05	7.9	5/16	11/16 - 16UNF	3/8	67	35	23	22
1J955-6-6	10	-06	9.5	3/8	11/16 - 16UNF	3/8	72	36	29	22
1J955-8-8	12	-08	12.7	1/2	13/16 - 16UNF	1/2	82	41	29	24
1J955-12-12	20	-12	19.0	3/4	1 3/16 - 12UNF	3/4	100	54	47	36
1J955-16-16	25	-16	25.4	1	1 7/16 - 12UNF	1	128	68	64	41

Material: Steel, surface protection according to DIN 50 961 Fe/Zn, special materials available upon request

Note: 56 series is the recommended fitting type, as the availability of 55 series will be limited in the future.

1J155 – O-Lok® ORFS 90° Elbow (Long Drop Length) UNF Swivel Nut ISO 12151-1

55 Series

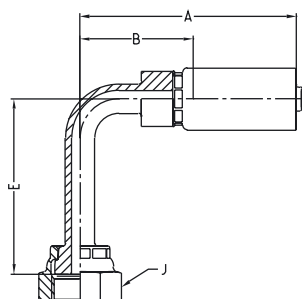

Part No. #	DN size mm inch				Connection Type		A mm	B mm	E mm	J mm
	mm	inch	Thread Size	Tube OD						
1J155-4-4	6	-04	6.4	1/4	9/16 - 18UNF	5/16	67	35	46	17
1J155-6-6	10	-06	9.5	3/8	11/16 - 16UNF	3/8	72	36	54	22
1J155-8-6	10	-06	9.5	3/8	13/16 - 16UNF	1/2	72	36	64	24
1J155-8-8	12	-08	12.7	1/2	13/16 - 16UNF	1/2	82	41	64	24
1J155-12-12	20	-12	19.0	3/4	1 3/16 - 12UNF	3/4	100	54	96	36
1J155-16-16	25	-16	25.4	1	1 7/16 - 12UNF	1	128	68	114	41

Material: Steel, surface protection according to DIN 50 961 Fe/Zn, special materials available upon request

Note: 56 series is the recommended fitting type, as the availability of 55 series will be limited in the future.



14955 – Banjo Union DIN 7642

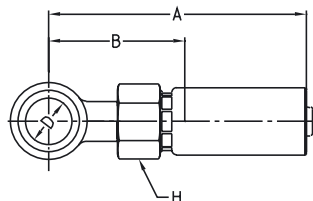

55 Series

Part No. #	DN size mm inch				Tube OD	A mm	B mm	H mm
14955-10-4	6	-04	6.4	1/4	10	65	34	17
14955-12-4	6	-04	6.4	1/4	12	67	36	–
14955-14-4	6	-04	6.4	1/4	14	72	40	17
14955-12-5	8	-05	7.9	5/16	12	61	30	–
14955-14-5	8	-05	7.9	5/16	14	72	40	17
14955-12-6	10	-06	9.5	3/8	12	66	29	–

Material: Steel, surface protection according to DIN 50 961 Fe/Zn, special materials available upon request

Note: 56 series is the recommended fitting type, as the availability of 55 series will be limited in the future.