

1CA58 – 24° Sealing Cone / O-Ring

Light Series – Metric Swivel Nut

ISO 12151-2

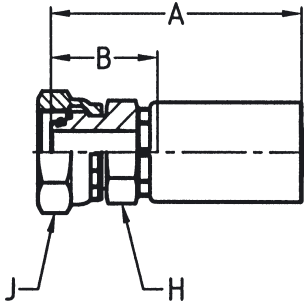

58 Series

Part No. #	DN size mm inch				Connection Type		A mm	B mm	H mm	J mm
	mm	inch	mm	inch	Thread Size	Tube OD				
1CA58-6-3	5	-03	4.8	3/16	M12x1.5	6	54	29	14	14
1CA58-8-4	6	-04	6.4	1/4	M14x1.5	8	60	29	17	19
1CA58-10-5	8	-05	7.9	5/16	M16x1.5	10	62	30	19	19
1CA58-12-5	8	-05	7.9	5/16	M18x1.5	12	63	31	19	22
1CA58-10-6	10	-06	9.5	3/8	M16x1.5	10	67	31	19	19
1CA58-12-6	10	-06	9.5	3/8	M18x1.5	12	68	31	19	22
1CA58-15-8	12	-08	12.7	1/2	M22x1.5	15	74	33	24	27
1CA58-18-10	16	-10	15.9	5/8	M26x1.5	18	80	35	27	32
1CA58-18-12	20	-12	19.0	3/4	M26x1.5	18	80	34	32	32
1CA58-22-12	20	-12	19.0	3/4	M30x2	22	80	34	32	36
1CA58-28-16	25	-16	25.4	1	M36x2	28	101	41	36	46

Material: Steel, surface protection according to DIN 50 961 Fe/Zn, special materials available upon request

1CE58 – 24° Sealing Cone / O-Ring 45° Elbow

Light Series – Metric Swivel Nut

ISO 12151-2

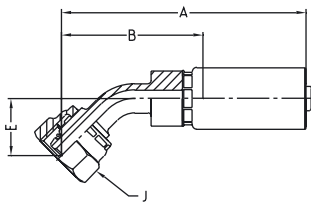

58 Series

Part No. #	DN size mm inch				Connection Type		A mm	B mm	E mm	H mm
	mm	inch	mm	inch	Thread Size	Tube OD				
1CE58-6-3	5	-03	4.8	3/16	M12x1.5	6	67	42	16	14
1CE58-8-4	6	-04	6.4	1/4	M14x1.5	8	75	43	18	19
1CE58-10-5	8	-05	7.9	5/16	M16x1.5	10	75	44	18	19
1CE58-10-6	10	-06	9.5	3/8	M16x1.5	10	83	46	19	19
1CE58-12-6	10	-06	9.5	3/8	M18x1.5	12	83	46	19	22
1CE58-15-8	12	-08	12.7	1/2	M22x1.5	15	92	51	21	27
1CE58-18-10	16	-10	15.9	5/8	M26x1.5	18	101	56	23	32
1CE58-18-12	20	-12	19.0	3/4	M26x1.5	18	108	62	25	32
1CE58-22-12	20	-12	19.0	3/4	M30x2	22	108	62	26	36

Material: Steel, surface protection according to DIN 50 961 Fe/Zn, special materials available upon request



1CF58 – Sealing Cone / O-Ring 90° Elbow

Light Series – Metric Swivel Nut

ISO 12151-2

58 Series

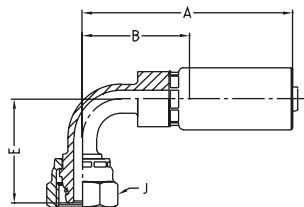

Part No. #	DN size mm inch				Connection Type		A mm	B mm	E mm	H mm
	mm	inch	mm	inch	Thread Size	Tube OD				
1CF58-6-3	5	-03	4.8	3/16	M12x1.5	6	55	30	29	14
1CF58-8-4	6	-04	6.4	1/6	M14x1.5	8	64	32	32	19
1CF58-10-5	8	-05	7.9	5/16	M16x1.5	10	65	33	32	19
1CF58-10-6	10	-06	9.5	3/8	M16x1.5	10	73	36	35	19
1CF58-12-6	10	-06	9.5	3/8	M18x1.5	12	73	36	35	22
1CF58-15-8	12	-08	12.7	1/2	M22x1.5	15	82	41	42	27
1CF58-18-10	16	-10	15.9	5/8	M26x1.5	18	91	46	46	32
1CF58-18-12	20	-12	19.0	3/4	M26x1.5	18	100	54	54	32
1CF58-22-12	20	-12	19.0	3/4	M30x2	22	100	54	52	36
1CF58-28-16	25	-16	25.4	1	M36x2	28	122	62	65	46

Material: Steel, surface protection according to DIN 50 961 Fe/Zn, special materials available upon request

1D058 – Metric Male 24° Cone

Light Series

ISO 12151-2

58 Series

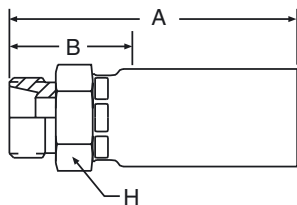

Part No. #	DN size mm inch				Connection Type		A mm	B mm	H mm
	mm	inch	mm	inch	Thread Size	Tube OD			
1D058-6-3	5	-03	4.8	3/16	M12x1.5	6	49	23	17
1D058-8-4	6	-04	6.4	1/4	M14x1.5	8	55	23	19
1D058-10-5	8	-05	7.9	5/16	M16x1.5	10	58	26	19
1D058-12-5	8	-05	7.9	5/16	M18x1.5	12	59	27	19
1D058-10-6	10	-06	9.5	3/8	M16x1.5	10	63	26	22
1D058-12-6	10	-06	9.5	3/8	M18x1.5	12	64	27	22
1D058-15-6	10	-06	9.5	3/8	M22x1.5	15	67	30	27
1D058-15-8	12	-08	12.7	1/2	M22x1.5	15	71	30	27
1D058-18-12	20	-12	19.0	3/4	M26x1.5	18	76	30	32
1D058-22-12	20	-12	19.0	3/4	M30x2	22	77	31	36
1D058-28-16	25	-16	25.4	1	M36x2	28	91	31	41

Material: Steel, surface protection according to DIN 50 961 Fe/Zn, special materials available upon request

1C658 – Sealing Head

Heavy Series Metric Swivel Nut

58 Series

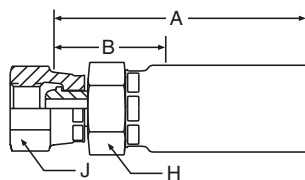

Part No. #	DN size mm inch				Connection Type		A mm	B mm	H mm	J mm
	mm	inch	Thread Size	Tube OD						
1C658-8-3	5	-03	4.8	3/16	M16x1.5	8	53	28	17	19
1C658-10-4	6	-04	6.4	1/4	M18x1.5	10	60	28	19	22
1C658-12-5	8	-05	7.9	5/16	M20x1.5	12	64	32	22	24
1C658-12-6	10	-06	9.5	3/8	M20x1.5	12	69	32	22	24
1C658-14-6	10	-06	9.5	3/8	M22x1.5	14	66	30	24	27
1C658-14-8	12	-08	12.7	1/2	M22x1.5	14	71	30	24	27
1C658-16-8	12	-08	12.7	1/2	M24x1.5	16	72	31	27	30
1C658-20-12	20	-12	19.0	3/4	M30x2	20	84	38	32	36
1C658-25-12	20	-12	19.0	3/4	M36x2	25	82	36	36	46
1C658-30-16	25	-16	25.4	1	M42x2	30	102	42	38	50

Material: Steel, surface protection according to DIN 50 961 Fe/Zn, special materials available upon request

1C958 – 24° Sealing Cone / O-Ring

Heavy Series – Metric Swivel Nut ISO 12151-2

58 Series

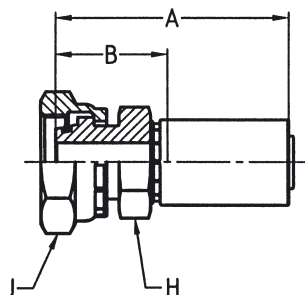

Part No. #	DN size mm inch				Connection Type		A mm	B mm	H mm	J mm
	mm	inch	Thread Size	Tube OD						
1C958-8-3	5	-03	4.8	3/16	M16x1.5	8	54	29	17	19
1C958-10-4	6	-04	6.4	1/4	M18x1.5	10	67	36	17	22
1C958-12-5	8	-05	7.9	5/16	M20x1.5	12	63	32	19	24
1C958-12-6	10	-06	9.5	3/8	M20x1.5	12	68	32	19	24
1C958-14-6	10	-06	9.5	3/8	M22x1.5	14	70	33	24	27
1C958-16-8	12	-08	12.7	1/2	M24x1.5	16	77	36	24	30
1C958-20-10	16	-10	15.9	5/8	M30x2	20	83	38	30	36
1C958-20-12	20	-12	19.0	3/4	M30x2	20	84	38	30	36
1C958-25-12	20	-12	19.0	3/4	M36x2	25	88	42	36	46
1C958-30-16	25	-16	25.4	1	M42x2	30	104	44	41	50

Material: Steel, surface protection according to DIN 50 961 Fe/Zn, special materials available upon request



10C58 – 24° Sealing Cone / O-Ring 45° Elbow

Heavy Series – Metric Swivel Nut ISO 12151-2

58 Series

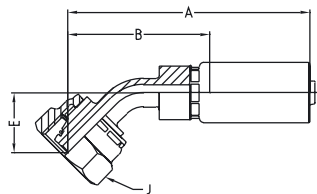

Part No. #	DN size mm inch				Connection Type		A mm	B mm	E mm	J mm
	mm	inch	Thread Size	Tube OD						
10C58-8-3	5	-03	4.8	3/16	M16x1.5	8	68	43	18	19
10C58-16-8	12	-08	12.7	1/2	M24x1.5	16	93	52	23	30

Material: Steel, surface protection according to DIN 50 961 Fe/Zn, special materials available upon request

11C58 – 24° Sealing Cone / O-Ring 90° Elbow

Heavy Series – Metric Swivel Nut ISO 12151-2

58 Series

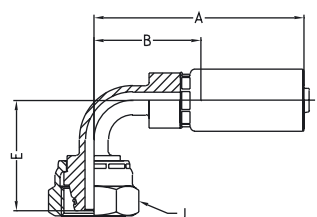

Part No. #	DN size mm inch				Connection Type		A mm	B mm	E mm	J mm
	mm	inch	Thread Size	Tube OD						
11C58-12-5	8	-05	7.9	5/16	M20x1.5	12	65	33	34	24
11C58-12-6	10	-06	9.5	3/8	M20x1.5	12	73	36	37	24
11C58-16-8	12	-08	12.7	1/2	M24x1.5	16	82	41	44	30

Material: Steel, surface protection according to DIN 50 961 Fe/Zn, special materials available upon request

1D258 – Metric Male 24° Cone Heavy Series ISO 12151-2

58 Series

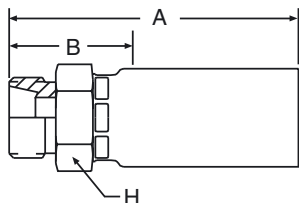

Part No. #	DN size mm inch				Connection Type		A mm	B mm	H mm
					Thread Size 	Tube OD 			
1D258-8-3	5	-03	4.8	3/16	M16x1.5	8	52	27	19
1D258-10-4	6	-04	6.4	1/4	M18x1.5	10	58	26	22
1D258-12-5	8	-05	7.9	5/16	M20x1.5	12	62	30	24
1D258-14-6	10	-06	9.5	3/8	M22x1.5	14	69	32	27
1D258-16-8	12	-08	12.7	1/2	M24x1.5	16	73	32	27
1D258-20-12	20	-12	19.0	3/4	M30x2	20	79	33	36
1D258-25-12	20	-12	19.0	3/4	M36x2	25	81	35	41
1D258-30-16	25	-16	25.4	1	M42x2	30	95	35	46

Material: Steel, surface protection according to DIN 50 961 Fe/Zn, special materials available upon request

19258 – Sealing Head (60°) BSP Swivel Nut

58 Series

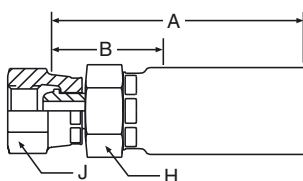

Part No. #	DN size mm inch				Connection Type		A mm	B mm	H mm	J mm
					Thread Size 	Tube OD 				
19258-4-3	5	-03	4.8	3/16	G 1/4	1/4	53	28	17	19
19258-4-4	6	-04	6.4	1/4	G 1/4	1/4	58	26	17	19
19258-6-5	8	-05	7.9	5/16	G 3/8	3/8	59	27	19	22
19258-6-6	10	-06	9.5	3/8	G 3/8	3/8	64	27	19	22
19258-8-8	12	-08	12.7	1/2	G 1/2	1/2	72	31	24	27
19258-10-8	12	-08	12.7	1/2	G 5/8	5/8	75	34	27	30
19258-12-12	20	-12	19.0	3/4	G 3/4	3/4	81	35	32	32
19258-16-16	25	-16	25.4	1	G 1	1	99	39	36	41

Material: Steel, surface protection according to DIN 50 961 Fe/Zn, special materials available upon request



1B158 – Sealing Head (60°) 45° Elbow BSP Swivel Nut

58 Series

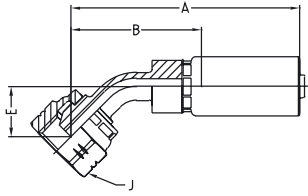

Part No. #	DN size mm inch				Connection Type		A mm	B mm	E mm	J mm
	mm	inch	mm	inch	Thread Size	Tube OD				
1B158-4-4	6	-04	6.4	1/4	G 1/4	1/4	73	41	16	19
1B158-6-5	8	-05	7.9	5/16	G 3/8	3/8	74	42	16	22
1B158-6-6	10	-06	9.5	3/8	G 3/8	3/8	81	45	17	22
1B158-8-8	12	-08	12.7	1/2	G 1/2	1/2	91	49	20	27
1B158-10-8	12	-08	12.7	1/2	G 5/8	5/8	89	48	19	30
1B158-12-12	20	-12	19.0	3/4	G 3/4	3/4	107	61	25	32
1B158-16-16	25	-16	25.4	1	G 1	1	131	71	29	41

Material: Steel, surface protection according to DIN 50 961 Fe/Zn, special materials available upon request

1B258 – Sealing Head (60°) 90° Elbow BSP Swivel Nut

58 Series

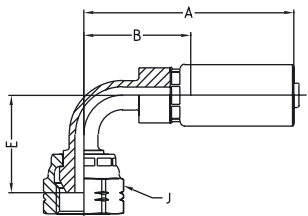

Part No. #	DN size mm inch				Connection Type		A mm	B mm	E mm	J mm
	mm	inch	mm	inch	Thread Size	Tube OD				
1B258-4-4	6	-04	6.4	1/4	G 1/4	1/4	64	32	28	19
1B258-6-5	8	-05	7.9	5/16	G 3/8	3/8	65	33	30	22
1B258-6-6	10	-06	9.5	3/8	G 3/8	3/8	73	36	33	22
1B258-8-8	12	-08	12.7	1/2	G 1/2	1/2	82	41	40	27
1B258-10-8	12	-08	12.7	1/2	G 5/8	5/8	82	41	38	30
1B258-12-12	20	-12	19.0	3/4	G 3/4	3/4	100	54	53	32
1B258-16-16	25	-16	25.4	1	G 1	1	127	67	65	41

Material: Steel, surface protection according to DIN 50 961 Fe/Zn, special materials available upon request

1D958 – BSP Male DIN 3852 Shape A

58 Series

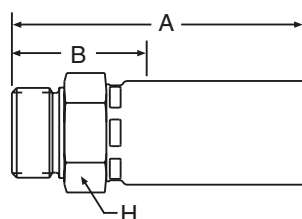

Part No. #	DN size mm inch				Connection Type		A mm	B mm	H mm
	mm	inch	mm	inch	Thread Size	Tube OD			
1D958-4-4	6	-04	6.4	1/4	G 1/4	1/4	58	26	19
1D958-6-5	8	-05	7.9	5/16	G 3/8	3/8	59	27	22
1D958-6-6	10	-06	9.5	3/8	G 3/8	3/8	64	27	22
1D958-8-8	12	-08	12.7	1/2	G 1/2	1/2	72	31	27
1D958-12-12	20	-12	19.0	3/4	G 3/4	3/4	80	34	32
1D958-16-16	25	-16	25.4	1	G 1	1	95	35	41

Material: Steel, surface protection according to DIN 50 961 Fe/Zn, special materials available upon request

10158 – NPTF Male - 60° Cone

58 Series

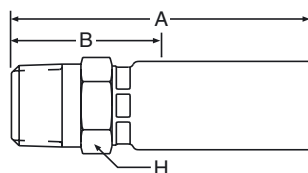

Part No. #	DN size mm inch				Connection Type		A mm	B mm	H mm
	mm	inch	mm	inch	Thread Size	Tube OD			
10158-2-2	3	-02	3.2	1/8	1/8 - 27NPTF	1/8	35	18	13
10158-2-3	5	-03	4.8	3/16	1/8 - 27NPTF	1/8	51	26	14
10158-4-3	5	-03	4.8	3/16	1/4 - 18NPTF	1/4	55	30	17
10158-6-3	5	-03	4.8	3/16	3/8 - 18NPTF	3/8	54	29	19
10158-2-4	6	-04	6.4	1/4	1/8 - 27NPTF	1/8	54	22	17
10158-4-4	6	-04	6.4	1/4	1/4 - 18NPTF	1/4	62	30	17
10158-6-4	6	-04	6.4	1/4	3/8 - 18NPTF	3/8	61	29	19
10158-4-5	8	-05	7.9	5/16	1/4 - 18NPTF	1/4	59	27	17
10158-6-5	8	-05	7.9	5/16	3/8 - 18NPTF	3/8	61	29	19
10158-4-6	10	-06	9.5	3/8	1/4 - 18NPTF	1/4	66	30	19
10158-6-6	10	-06	9.5	3/8	3/8 - 18NPTF	3/8	70	33	19
10158-8-6	10	-06	9.5	3/8	1/2 - 14NPTF	1/2	77	40	27
10158-6-8	12	-08	12.7	1/2	3/8 - 18NPTF	3/8	71	30	22
10158-8-8	12	-08	12.7	1/2	1/2 - 14NPTF	1/2	77	36	27
10158-12-12	20	-12	19.0	3/4	3/4 - 14NPTF	3/4	82	36	30
10158-16-16	25	-16	25.4	1	1 - 11 1/2NPTF	1	104	44	41

Material: Steel, surface protection according to DIN 50 961 Fe/Zn, special materials available upon request

10658 – JIC - 37° Cone

UNF Swivel Nut

Material: Steel

58 Series

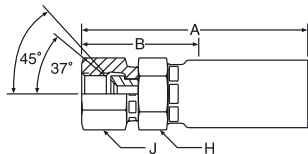

Part No. #	DN size mm inch				Connection Type		A mm	B mm	H mm	J mm
	mm	inch	Thread Size	Tube OD						
10658-3-2	3	-02	3.2	1/8	3/8 - 24UNF	3/16	33	16	13	14
10658-4-2	3	-02	3.2	1/8	7/16 - 20UNF	1/4	33	16	13	17
10658-4-3	5	-03	4.8	3/16	7/16 - 20UNF	1/4	55	30	16	17
10658-5-3	5	-03	4.8	3/16	1/2 - 20UNF	5/16	57	32	16	17
10658-4-4	6	-04	6.4	1/4	7/16 - 20UNF	1/4	65	33	17	17
10658-5-4	6	-04	6.4	1/4	1/2 - 20UNF	5/16	65	33	16	17
10658-6-4	6	-04	6.4	1/4	9/16 - 18UNF	3/8	67	35	17	19
10658-5-5	8	-05	7.9	5/16	1/2 - 20UNF	5/16	65	33	16	17
10658-6-5	8	-05	7.9	5/16	9/16 - 18UNF	3/8	65	33	16	19
10658-6-6	10	-06	9.5	3/8	9/16 - 18UNF	3/8	69	33	19	19
10658-8-6	10	-06	9.5	3/8	3/4 - 16UNF	1/2	72	35	19	24
10658-6-8	12	-08	12.7	1/2	9/16 - 18UNF	3/8	76	35	22	19
10658-8-8	12	-08	12.7	1/2	3/4 - 16UNF	1/2	79	38	22	22
10658-10-8	12	-08	12.7	1/2	7/8 - 14UNF	5/8	82	41	22	27
10658-12-8	12	-08	12.7	1/2	1 1/16 - 12UNF	3/4	83	42	27	32
10658-12-12	20	-12	19.0	3/4	1 1/16 - 12UNF	3/4	88	42	30	32
10658-16-12	20	-12	19.0	3/4	1 5/16 - 12UNF	1	90	44	36	38
10658-16-16	25	-16	25.4	1	1 5/16 - 12UNF	1	104	44	36	38

Material: Steel, surface protection according to DIN 50 961 Fe/Zn, special materials available upon request

Material: Stainless Steel

Part No. #	DN size mm inch				Connection Type		A mm	B mm	H mm	J mm
	mm	inch	Thread Size	Tube OD						
10658-4-3C	5	-03	4.8	3/16	7/16 - 20UNF	1/4	55	30	16	17
10658-4-4C	6	-04	6.4	1/4	7/16 - 20UNF	1/4	65	33	17	17
10658-6-5C	8	-05	7.9	5/16	9/16 - 18UNF	3/8	65	33	16	19
10658-6-6C	10	-06	9.5	3/8	9/16 - 18UNF	3/8	69	33	19	19
10658-8-6C	10	-06	9.5	3/8	3/4 - 16UNF	1/2	72	35	19	24
10658-8-8C	12	-08	12.7	1/2	3/4 - 16UNF	1/2	79	38	22	22
10658-10-8C	12	-08	12.7	1/2	7/8 - 14UNF	5/8	82	41	22	27
10658-12-12C	20	-12	19.0	3/4	1 1/16 - 12UNF	3/4	88	42	30	32
10658-16-16C	25	-16	25.4	1	1 5/16 - 12UNF	1	104	44	36	38

Material: Stainless Steel (AISI 316)

13958 – JIC - 37° Cone 90° Elbow UNF Swivel Nut

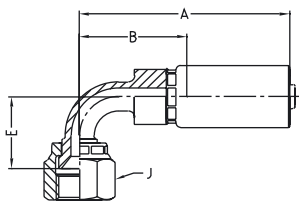

58 Series

Part No. #	DN size mm inch				Connection Type		A mm	B mm	E mm	H mm
	mm	inch	Thread Size	Tube OD	Thread Size	Tube OD				
13958-4-3-SM	5	-03	4.8	3/16	7/16 - 20UNF	1/4	55	30	21	17
13958-4-4-SM	6	-04	6.4	1/4	7/16 - 20UNF	1/4	64	32	21	17
13958-5-4-SM	6	-04	6.4	1/4	1/2 - 20UNF	5/16	64	32	25	17
13958-6-4-SM	6	-04	6.4	1/4	9/16 - 18UNF	3/8	64	32	22	19
13958-6-5-SM	8	-05	7.9	5/16	9/16 - 18UNF	3/8	65	33	22	19
13958-6-6-SM	10	-06	9.5	3/8	9/16 - 18UNF	3/8	73	36	28	19
13958-8-6-SM	10	-06	9.5	3/8	3/4 - 16UNF	1/2	71	34	29	22
13958-8-8-SM	12	-08	12.7	1/2	3/4 - 16UNF	1/2	77	36	29	22
13958-10-8-SM	12	-08	12.7	1/2	7/8 - 14UNF	5/8	77	36	32	27
13958-12-12-SM	20	-12	19.0	3/4	1 1/16 - 12UNF	3/4	97	51	46	32
13958-16-16-SM	25	-16	25.4	1	1 5/16 - 12UNF	1	121	61	55	41

Material: Steel, surface protection according to DIN 50 961 Fe/Zn, special materials available upon request

1JC58 – O-Lok® ORFS (Short Version) UNF Swivel Nut ISO 12151-1

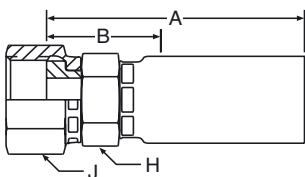

58 Series

Part No. #	DN size mm inch				Connection Type		A mm	B mm	H mm	J mm
	mm	inch	Thread Size	Tube OD	Thread Size	Tube OD				
1JC58-4-3-SM	5	-03	4.8	3/16	9/16 - 18UNF	1/4	47	22	17	17
1JC58-4-4-SM	6	-04	6.4	1/4	9/16 - 18UNF	1/4	53	22	17	17
1JC58-6-4-SM	6	-04	6.4	1/4	11/16 - 16UNF	3/8	59	27	19	22
1JC58-4-5-SM	8	-05	7.9	5/16	9/16 - 18UNF	1/4	53	22	17	17
1JC58-6-5-SM	8	-05	7.9	5/16	11/16 - 16UNF	3/8	56	25	19	22
1JC58-6-6-SM	10	-06	9.5	3/8	11/16 - 16UNF	3/8	61	25	19	22
1JC58-8-6-SM	10	-06	9.5	3/8	13/16 - 16UNF	1/2	63	27	22	24
1JC58-8-8-SM	12	-08	12.7	1/2	13/16 - 16UNF	1/2	69	27	24	24
1JC58-10-8-SM	12	-08	12.7	1/2	1 - 14UNF	5/8	73	32	30	30
1JC58-12-12-SM	20	-12	19.0	3/4	1 3/16 - 12UNF	3/4	79	33	32	36
1JC58-16-16-SM	25	-16	25.4	1	1 7/16 - 12UNF	1	96	36	36	41

Material: Steel, surface protection according to DIN 50 961 Fe/Zn, special materials available upon request



1JS58 – O-Lok® ORFS UNF Swivel Nut ISO 12151-1

58 Series

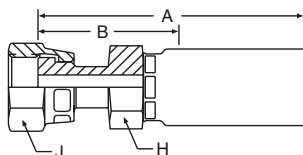

Part No. #	DN size mm inch				Connection Type		A mm	B mm	H mm	J mm
	mm	inch	mm	inch	Thread Size	Tube OD				
1JS58-4-3-SM	5	-03	4.8	3/16	9/16 - 18UNF	1/4	60	35	17	17
1JS58-4-4-SM	6	-04	6.4	1/4	9/16 - 18UNF	1/4	67	35	17	17
1JS58-6-4-SM	6	-04	6.4	1/4	11/16 - 16UNF	3/8	66	35	19	22
1JS58-4-5-SM	8	-05	7.9	5/16	9/16 - 18UNF	1/4	67	35	17	17
1JS58-6-5-SM	8	-05	7.9	5/16	11/16 - 16UNF	3/8	66	35	19	22
1JS58-6-6-SM	10	-06	9.5	3/8	11/16 - 16UNF	3/8	71	35	19	22
1JS58-8-6-SM	10	-06	9.5	3/8	13/16 - 16UNF	1/2	75	38	22	24
1JS58-8-8-SM	12	-08	12.7	1/2	13/16 - 16UNF	1/2	80	38	22	24
1JS58-10-10-SM	16	-10	15.9	5/8	1 - 14UNF	5/8	90	44	30	30
1JS58-12-12-SM	20	-12	19.0	3/4	1 3/16 - 12UNF	3/4	94	48	32	36
1JS58-16-16-SM	25	-16	25.4	1	1 7/16 - 12UNF	1	112	52	36	41

Material: Steel, surface protection according to DIN 50 961 Fe/Zn, special materials available upon request

1J758 – O-Lok® ORFS 45° Elbow UNF Swivel Nut ISO 12151-1

58 Series

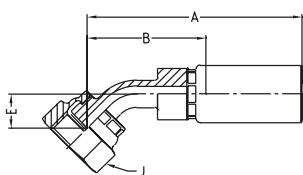

Part No. #	DN size mm inch				Connection Type		A mm	B mm	E mm	J mm
	mm	inch	mm	inch	Thread Size	Tube OD				
1J758-4-4	6	-04	6.4	1/4	9/16 - 18UNF	5/16	71	39	10	17
1J758-6-4	6	-04	6.4	1/4	11/16 - 16UNF	3/8	73	41	12	22
1J758-6-6	10	-06	9.5	3/8	11/16 - 16UNF	3/8	78	41	14	22
1J758-8-6	10	-06	9.5	3/8	13/16 - 16UNF	1/2	78	42	14	24
1J758-8-8	12	-08	12.7	1/2	13/16 - 16UNF	1/2	83	42	12	24
1J758-12-12	20	-12	19.0	3/4	1 3/16 - 12UNF	3/4	103	57	21	36
1J758-16-16	25	-16	25.4	1	1 7/16 - 12UNF	1	130	70	26	41

Material: Steel, surface protection according to DIN 50 961 Fe/Zn, special materials available upon request

1J958 – O-Lok® ORFS 90° Elbow UNF Swivel Nut ISO 12151-1

58 Series

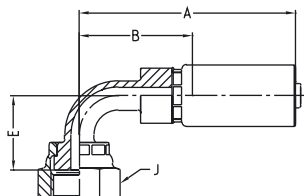

Part No. #	DN size mm inch				Connection Type		A mm	B mm	E mm	J mm
	mm	inch	Thread Size	Tube OD						
1J958-4-4	6	-04	6.4	1/4	9/16 - 18UNF	5/16	67	35	21	17
1J958-6-4	6	-04	6.4	1/4	11/16 - 16UNF	3/8	68	36	23	22
1J958-6-5	8	-05	7.9	5/16	11/16 - 16UNF	3/8	67	35	23	22
1J958-6-6	10	-06	9.5	3/8	11/16 - 16UNF	3/8	72	36	29	22
1J958-8-8	12	-08	12.7	1/2	13/16 - 16UNF	1/2	82	41	29	24
1J958-12-12	20	-12	19.0	3/4	1 3/16 - 12UNF	3/4	100	54	47	36
1J958-16-16	25	-16	25.4	1	1 7/16 - 12UNF	1	128	68	64	41

Material: Steel, surface protection according to DIN 50 961 Fe/Zn, special materials available upon request

